



Water Deflector and Protective Faucet Cover with Bubble Bath Dispenser

User Guide (English)



WARNING

- NEVER leave child unattended while bathing
- This product is not a toy
- Flo should be installed by an adult and used only under adult supervision

Prior to use, remove all packaging and fasteners and discard properly.

Patent pending

Actual product styling and colors may vary.

Patents, trademarks, copyrights, and designs are exclusively owned by Boon Inc.

Boon Inc. products are made with the highest quality materials and comply with applicable regulations and standards.

Made in China

Item #601

Satisfaction Guarantee

Before returning this product to the store for any reason, please call us so that we may resolve your questions or concerns.

Thank you.



©2006 Boon Inc.
info@booninc.com • 1.888 Frog Pod
www.booninc.com

INSTALLATION & REMOVAL

1. To install Flo, squeeze front top and bottom sections together and fit over faucet. To remove Flo, squeeze front sections and pull off faucet.
2. **NOTE: Make sure that front of faucet extends over inside flap as shown below.**
3. Be sure that shower diverter is accessible through top opening.

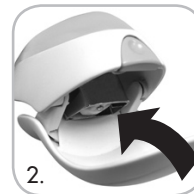

USING BUBBLE BATH DISPENSER

- To fill bubble bath dispenser, lift lid and pour liquid bubble bath into reservoir. Fill to desired level. Do not overfill.
- To dispense bubble bath into water stream, press green button on front of Flo.



CLEANING

- To clean all surfaces, use warm soapy water and a soft cloth. Do not use abrasive cleaners.
- To clean bubble bath dispenser, press button while flushing reservoir with warm water.